

# SIGNATURE

## NORTH EAST

OFFICIALLY RATED THE NO.1 ESTATE AGENT IN THE NORTH EAST





57-62  
Alexandra Way

 Alexandra Way, Wallsend NE28 9JX

# Alexandrea Way, Wallsend NE28 9JX

**Asking Price £89,950**

Signature North East are delighted to welcome to the market this well-presented two bedroom top floor apartment, ideally located in Wallsend. Positioned in a great location, the property offers the perfect balance of convenience and community. The area benefits from excellent transport links, including nearby Metro services providing quick access to Newcastle upon Tyne and the wider Tyne & Wear region, as well as easy access to the A19 and Tyne Tunnel for commuters. Residents also enjoy a range of local shops, supermarkets, schools and leisure facilities, in addition to attractive green open spaces close by.

This property benefits from no chain.

Upon entering, you are welcomed into the central hallway which leads you through the home. The first step brings you into the spacious open plan living room, offering ample space for a range of desired furnishings. The open plan kitchen provides a plethora of storage through wall and base units, complemented by ample worktop space. The kitchen is complete with an integrated oven and hob and included within the sale are the fridge freezer, washing machine and dishwasher.

Continuing your journey through the apartment, you will discover two bedrooms, both of which can comfortably accommodate a double bed along with additional furnishings. Bedroom one benefits from direct access to the bathroom, while bedroom two features a fitted storage cupboard, enhancing practicality. Completing the apartment is the bathroom, fitted with a bathtub and overhead shower, hand basin and W.C.

Externally, this home offers an allocated parking space together with visitor parking bays, providing convenience for residents and guests alike. The building is also accessed via a secure intercom entry system.



PLEASE NOTE THAT THE VENDOR HAS CERTIFIED THE PROPERTY INFORMATION AND IMAGES.

# PROPERTY FLOORPLAN

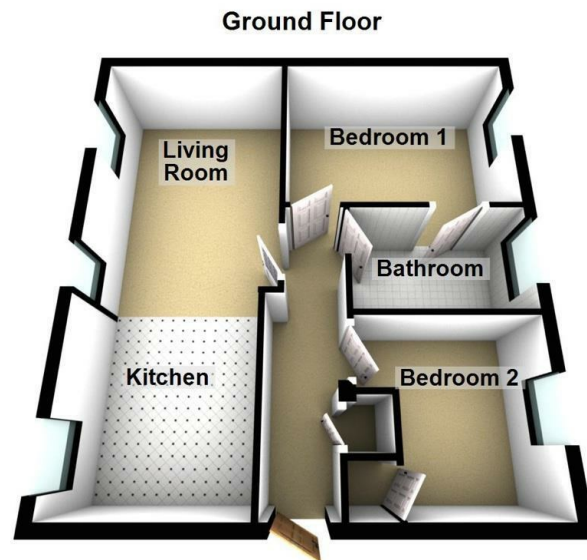

Total area: approx. 52.8 sq. metres (568.6 sq. feet)

## Measurements:

Living Room  
13'11" x 9'11"

Kitchen  
10'3" x 9'2"

Bedroom One  
9'1" x 12'6"

Bedroom Two  
9'1" x 9'1"

Bathroom  
5'6" x 9'1"

## Energy Efficiency Rating

	Current	Potential
<i>Very energy efficient - lower running costs</i>		
(92 plus) <b>A</b>		
(81-91) <b>B</b>		
(69-80) <b>C</b>	72	80
(55-68) <b>D</b>		
(39-54) <b>E</b>		
(21-38) <b>F</b>		
(1-20) <b>G</b>		
<i>Not energy efficient - higher running costs</i>		
<b>England &amp; Wales</b>	EU Directive 2002/91/EC	





More 5 Star Customer Reviews than any other Agent based in the North East on allAgents.co.uk



**SALES**

**LETTINGS**

**FINANCE**

**LAW**

**WE COVER THE WHOLE OF THE NORTH EAST**

Whitley Bay  
0191 251 3344

Cramlington  
01670 897 213

Tynemouth  
0191 296 6689

Morpeth  
01670 513 966

Ponteland  
01661 820 082

Wallsend  
0191 432 4151

Alnwick  
01665 511 800

Heaton  
0191 432 4275

Forest Hall  
0191 266 9966

Other locations  
0191 640 3523

Newcastle  
0191 640 2284

Durham  
0191 303 8252

Gosforth  
0191 640 3523

Sunderland  
0191 543 6390

Whickham  
0191 432 5102

Gateshead  
0191 432 4294

Jesmond  
0191 281 1037

Killingworth  
0191 640 3602

Ryton  
0191 413 9845

Head Office &  
Lettings  
0191 253 4815

\*Highest recommended 5-star reviews than any other Estate Agent based in the North East on allAgents.co.uk - The UK's Largest Customer Review Website for the Property Industry & Awarded Best Estate Agency 2018 & 2019 - North East England by SME News